

BUFFALO

AIR HANDLING

FOAM PANEL CONSTRUCTION

FEATURES AND BENEFITS

- 2", 3" AND 4" PANELS
- ALUMINUM EXTRUSIONS
- NO THROUGH METAL
- 'R' VALUE OF 6.8/INCH
- STRENGTH AND RIGIDITY
- AESTHETICS

Specifications

Aluminum Walls

All panels shall be double wall and fabricated of .063" (.050") (.040") embossed aluminum outer shell with a .040 solid aluminum inner. The unit casing shall be no through metal construction using aluminum extrusions with a polyurethane resin thermal bridge. All panel seams will be caulked with sealant.

Galvanized Walls

All panels shall be double wall and fabricated of 14 gauge (16) (18) G90 galvanized steel outer shell with an 18 gauge (20) (22) solid galvanized inner, except in the chilled water coil section and downstream, of the final filters, which shall be solid 18 gauge (20) 304 stainless steel. The unit casing shall be no through metal construction using aluminum extrusions with a polyurethane resin thermal bridge. All panel seams will be caulked with sealant.

Insulation

All exterior panels and roof shall be insulated with polyurethane foam insulation fill between the outer wall and inner liner. Floors shall be insulated with a minimum of 2" thick foam insulation to completely fill all contours on the underside of the floor. Insulation is UL Class I rated. A bottom cover sheet shall completely encapsulate the insulation.

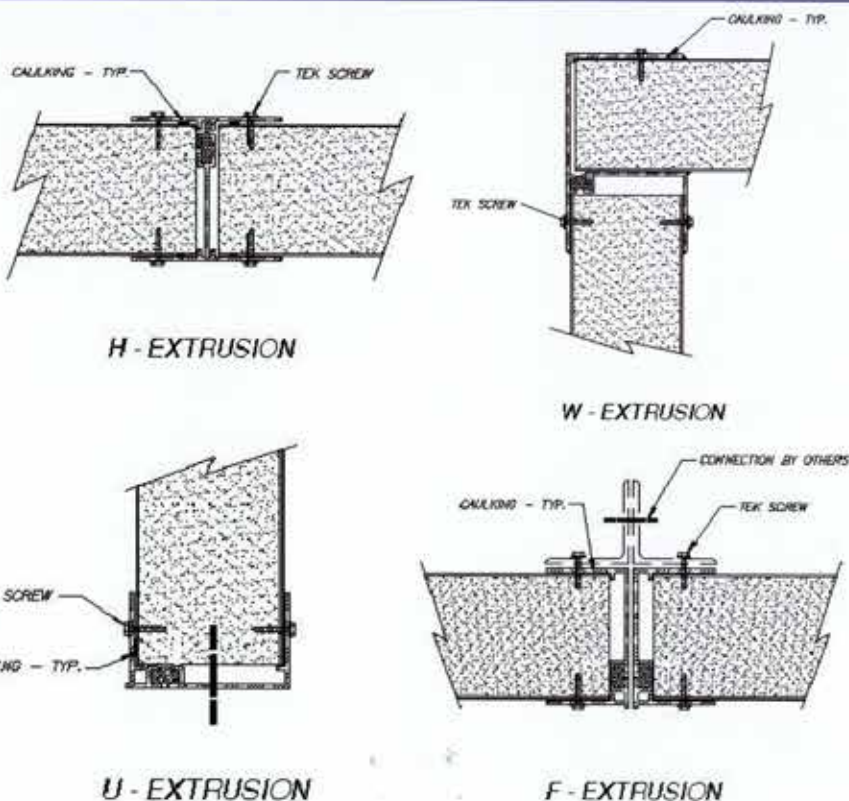



Mailing Address: P.O. Box 9058 • San Diego, CA 92169

Packages Only: 4629 Cass St., Ste. 258 • San Diego, CA 92109

Cell: (619) 804-4000 • Office: (858) 272-1779 • Fax: (858) 272-1777

mkduncan@flash.net www.duncanenterprises.com